



WILDOMAR COMMERCE CENTER



Shovel ready land and/or permit ready buildings for your growing business.



www.wildomarcc.com

FOR MORE INFO



BUILDINGS 1/2

- Two freestanding buildings each on their own legal parcel.
- Building 1: approximately 17,255 s.f. divisible in half.
- Building 2: approximately 15,000 s.f. divisible in half.
- Buildings will be set up as "condo ready" so that a total of four (4) units can be conveyed.
- Large secured service yard in back of the buildings.
- 24' clearance.

BUILDING 3

64,008 Square Feet Available on 4.7 Acres

- Divisible to 12,468 SF to 13,024 SF
- 130' Truck Court
- 32' Clearance
- ESFR Sprinklers with K-25 Heads
- 25 Dock High Doors / 5 Ramp Level Doors
- 2,000 AMP UGPS, 277/480V Power Expandable to 4000 A

BUILDING 4

95,702 Square Feet Available on 7.28 Acres

- Divisible to approx. 19,000 SF to 37,000 SF
- 135' Secured Truck Court
- 32' Clearance
- ESFR Sprinklers with K-25 Heads
- 23 Dock High Doors / 4 Ramp Level Doors
- 2,000 AMP UGPS, 277/480V Power Expandable to 4,000 A

BUILDING 5

99,940 Square Feet Available on 7.15 Acres

- Divisible into two (2) spaces
- 206' Truck Court
- 32' Clearance
- ESFR Sprinklers with K-25 Heads
- 27 Dock High Doors / 2 Ramp Level Doors
- 2,000 AMP UGPS, 277/480V Power Expandable to 4,000 A

PROPERTY HIGHLIGHTS

- 23 Net acres with pads formed
- Each building has a large yard
- Buildings 3-5 offer huge power capacity via an available 4,000 amp, 277/480 V trench duct system
- Site zoning is super flexible

LOCATION FEATURES:

- SWC of Clinton Keith Rd. & Elizabeth Ln.
- Less than one (1) mile east from Clinton Keith Rd. interchange with I-15 Fwy
- Many great food/service options nearby.
- Future signalized intersection at primary corner



KEN ANDERSEN | CCIM, SIOR

Executive Vice President
CADRE #00902084
kandersen@daumcommercial.com
P: 909 912.0002 | F: 909 350.3993

DAN FOYE

Executive Vice President
CADRE #01292002
dfoye@daumcommercial.com
P: 909 980.1234 | F: 909 980.3775

GABE DUPLANTIER

Associate
CADRE #02178517
gduplantier@daumcommercial.com
D: 909 912.0008 | M: 714 421.9275

LISTING TEAM

Land or Buildings For Your Growing Business.



KEY BUILDING FEATURES

LOT	BLDG. S.F.	LAND AREA (AC.)	COVERAGE	TRUCK COURT
-----	------------	-----------------	----------	-------------

1	17,256	1.90	21%	94'
2	15,000	1.81	19%	94'
3	64,008	4.70	31%	130'
4	95,702	7.28	30%	135'
5	99,940	7.15	32%	206'
	291,906			

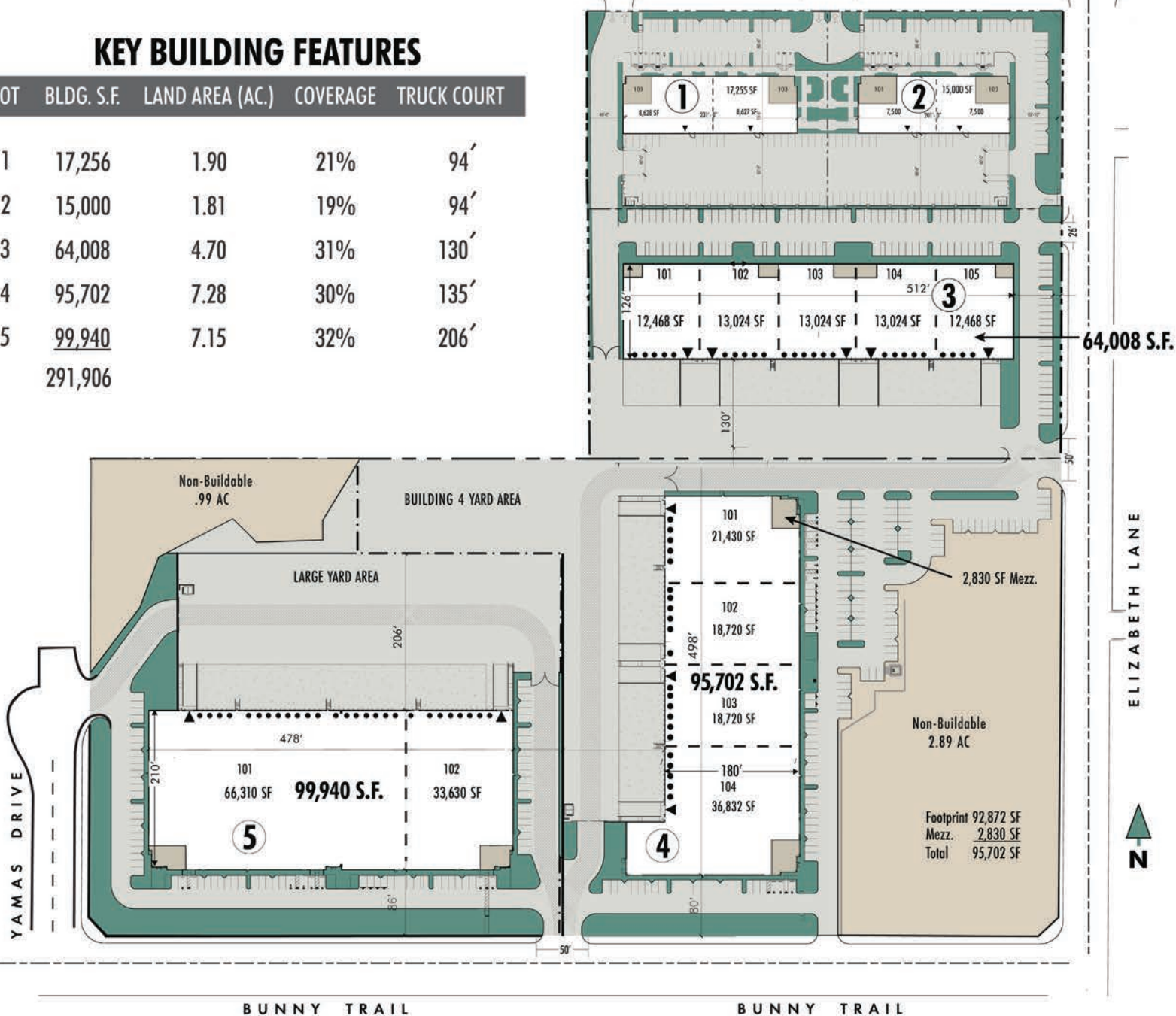

LEGEND

- Dock door
- ▼ Ramp door
- - - Potential deminishing wall



CHARLEY BLACK
Senior Vice President
CADRE #01000597
cblack@leetemecula.com
P: 951 445.4507

GORDON MIZE
Senior Vice President
CADRE #01275376
gmize@leetemecula.com
P: 951 445.4504

For more information on the City of Wildomar:

KIMBERLY DAVIDSON
Economic Development Director & Public Information Officer
Business Registrations Office
kdavidson@wildomar.gov
P: 951 297.3457

WILDOMAR COMMERCE CENTER



The information contained herein has been obtained from sources we deem reliable. While we have no reason to doubt its accuracy, we do not guarantee it. All rights reserved.